

# RC121-BD040 R.C. HAMMER

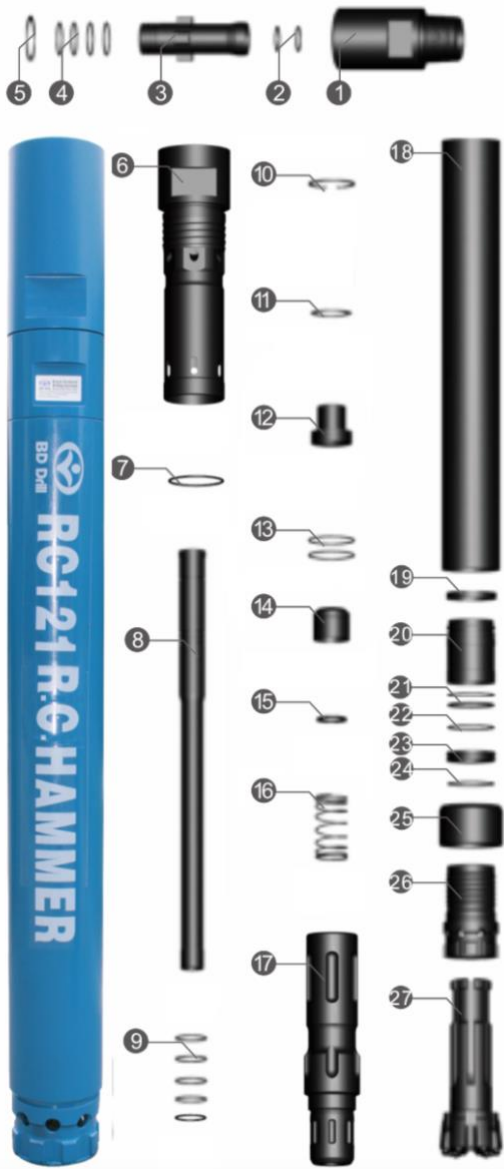

**Black Diamond**  
Drilling Services Australia

4.5" R.C. Hammers	Item No.	Crossover Sub Remet 4 1/2" (Thread available in Drill Star, Matrix and Blank
-------------------	----------	--



1	DAPT-PM45BR45-121	Pin to Box Crossover Sub Assembly Od121mm
2	ADAPT-SUB-PM45BR45-121	Pin to Box Crossover Sub Od121mm
3	SK-BR45	O Ring (Box Remet 4.5")
4	ATUBE-PM45BR45	Adaptor Tube Pin to Box
5	SKOPM45	O Ring (Pin Metzke 4.5)
Item Description	Weight Kg	Part Number
6	Inner Cylinder	8.95 RC121-ICYL-M4.5
7	O Ring x 1	0.02 RC121-SK-ICYL
8	Sample Tube	5.2 RC121-STUBE-H
9	O Ring x 5	0.02 BD67/RC121-SK-STUBE
10	Circlip B	0.02 BD67/RC121-CIRCLIP-1
11	Air Screen	0.02 BD67/RC121-AIRSCREEN-1
12	Distribution Nozzle	0.48 BD67/RC121-DIST-1
13	"O" Ring x2	0.02 BD67/RC121-SK-DIST
14	Plunger/Check Valve	0.53 BD67/RC121-CVALVE-MHK
15	"Y" Ring x 1	0.02 BD67/545/547/RC121-SK-YRING
16	Spring	0.12 BD67/545/547/RC121-SPRING
17	Piston	14.1 BD52/RC121-PISTON
18	External Cylinder/Barrel/Wear Sleeve/Piston Case	19.4 RC121-ECYL-DK
19	Bush Retaining Ring	0.02 RC121-SRING-BUSH
20	Bearing Bush/Bush Drive Sub	1.85 RC121-BUSH
21	"O" Ring x 2	0.02 BD040/RC121-SK-BUSH
22	Bit Retaining Ring	0.31 BD040/RC121-SRING-HD
23	"O" Ring x 1	0.02 RC121/BD040-SK-SRING
24	Piston Retaining Ring	0.15 RC121-RRING
25	Shroud	2.2 BD040-136/133.5-DB
26	Drive Sub/Chuck	3.67 RC121/BD040-DSUB
27	Drill Bit	15.09 BD040-136DC-TV

## Technical Data

Length(Less bit)	Weight(Less bit)	External Diameter	Bit Shank	Hole Range	Connection Thread
1039mm	71.0kg	Φ121mm	RE040	Φ126- Φ146	Metzke 4.5" Remet 4.5"
Box Size	Impact rate At 2.4Mpa	Recommended rotation speed		Air Consumption	
1340x350x350mm	35Hz	25-40r/min		200-500(PSI) 300-1200(CFM)	