

BD040 R.C. HAMMER



BD Drill

Black Diamond

Drilling Services Australia

| 5" R.C. Hammers | Item Description | Weight Kg | Part Number |
|-----------------|------------------|-----------|-------------|
|-----------------|------------------|-----------|-------------|

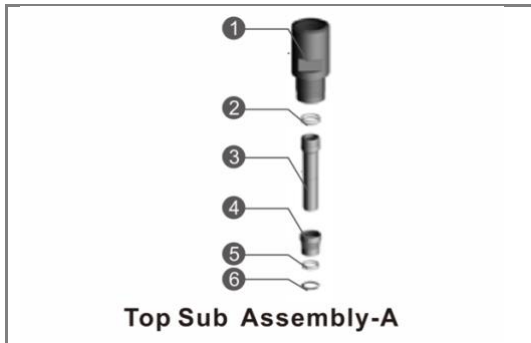

| A Top sub Assy Remet 4" | | | |
|-------------------------|-----------------------------------|------|---------------------|
| ① | Top Sub-Remet 4" | 7.79 | BD040-TSUB-R4 |
| ② | O Ring (Adaptor Tube Remet 4") x2 | 0.02 | BD040-SK-ASCREEN-R4 |
| ③ | Adaptor Tube Remet 4" | 1.51 | BD040-ASCREEN-R4 |
| ④ | Air Screen | 0.5 | BD040-AIRSCREEN |
| ⑤ | O Ring (Air Screen) x 2 | 0.02 | BD040-SK-AIRSCREEN |
| ⑥ | Circlip | 0.02 | BD040-CIRCLIP |

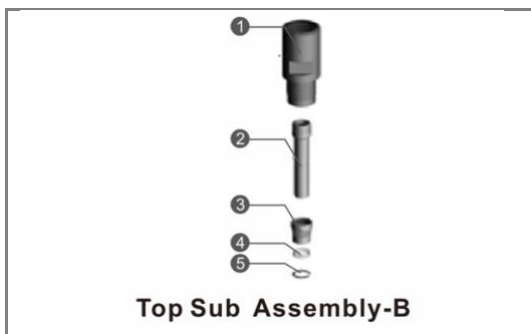

| B Top sub Assy Metzke 4" | | | |
|--------------------------|-------------------------|------|--------------------|
| ① | Top Sub-Metzke 4" | 7.79 | BD040-TSUB-M4 |
| ② | Adaptor Tube Metzke 4" | 1.51 | BD040-ASCREEN-M4 |
| ③ | Air Screen | 0.5 | BD040-AIRSCREEN |
| ④ | O Ring (Air Screen) x 2 | 0.02 | BD040-SK-AIRSCREEN |
| ⑤ | Circlip | 0.02 | BD040-CIRCLIP |

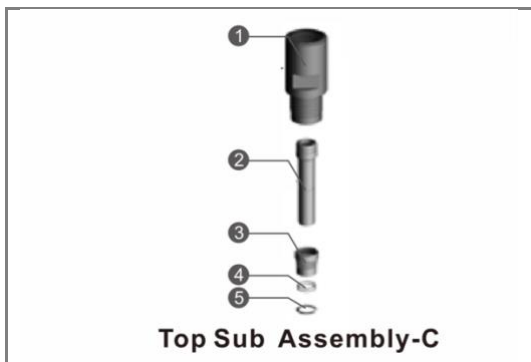

| C Top sub Assy Metzke 4.5" | | | |
|----------------------------|--------------------------|------|--------------------|
| ① | Top Sub-Metzke 4.5" | 7.79 | BD040-TSUB-M4.5 |
| ② | Adaptor Tube Metzke 4.5" | 1.51 | BD040-ASCREEN-M4.5 |
| ③ | Air Screen | 0.5 | BD040-AIRSCREEN |
| ④ | O Ring (Air Screen) x 2 | 0.02 | BD040-SK-AIRSCREEN |
| ⑤ | Circlip | 0.02 | BD040-CIRCLIP |

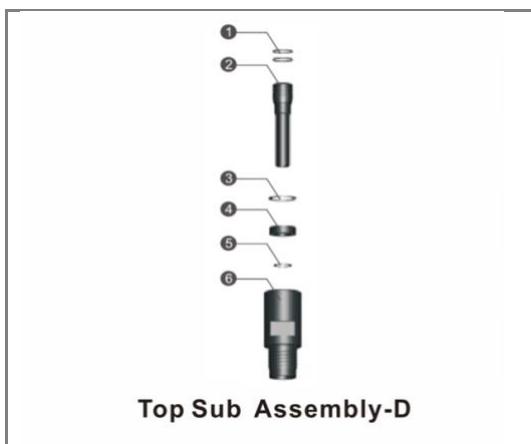

| D Top sub Assy Remet 4.5" | | | |
|---------------------------|-------------------------------------|------|--------------------------|
| ① | O Ring (Adaptor Tube Remet 4.5") x2 | 0.02 | BD040/52-SK-ASCREEN-R4.5 |
| ② | Adaptor Tube Remet 4.5" | 1.51 | BD040/52-ASCREEN-R4.5 |
| ③ | Circlip A | 0.02 | BD040/52-CIRCLIP-1 |
| ④ | Air Screen | 0.5 | BD040/52-AIRSCREEN-R4.5 |
| ⑤ | Circlip B | 0.02 | BD040/52-CIRCLIP-2 |
| ⑥ | Top Sub-Remet 4.5" | 7.79 | BD040-TSUB-R4.5 |

BD040 R.C. HAMMER



Black Diamond

| 5" R.C. Hammers | Item Description | Weight Kg | Part Number |
|-----------------|---|-----------|----------------------|
| | 7 Check Valve/Plunger | 0.63 | BD040/52-CVALVE |
| | 8 Y Ring (Check Valve) | 0.01 | BD040/52-SK-CVALVE |
| | 9 Spring | 0.12 | BD040/52-SPRING |
| | 10 Spring Seat | 0.12 | BD040/52-SSEAT |
| | 11 Make Up Ring, Steel | 0.09 | BD040/52-MUR-STEEL |
| | 12 Make Up Ring, Viton | 0.06 | BD040/52-MUR-VITON |
| | 13 Distributor | 1.75 | BD040/52-DIST |
| | 14 O Ring (Distributor) x 1 | 0.02 | BD040/52-SK-DIST |
| | 15 O Ring (Sample Tube) x 2 | 0.02 | BD040-SK-STUBE1 |
| | 16 O Ring (Sample Tube) x 1 | 0.02 | BD040-SK-STUBE2 |
| | 17 Sample Tube Lower | 4.32 | BD040-STUBE |
| | 18 Mount Sample Tube | 1 | BD040-STUBE-MOUNT |
| | 19 O Ring (Mount Sample Tube) x 1 | 0.02 | BD040-SK-STUBE-M |
| | 20 Inner Cylinder | 7.69 | BD040-ICYL |
| | 21 Piston | 13.63 | BD040-PISTON |
| | 22 External Cylinder/Barrel/Piston Case | 24.14 | BD040-ECYL |
| | 23 Piston Retaining Ring | 0.1 | BD040-PRING |
| | 24 Bearing Bush | 1.89 | BD040-BUSH |
| | 25 O Ring (Bearing Bush) x 1 | 0.02 | BD040-SK-BUSH1 |
| | 26 O Ring (Bearing Bush) x 1 | 0.02 | BD040-SK-BUSH2 |
| | 27 Bit Stop Ring | 0.31 | BD040-SRING |
| | 28 O Ring (Bit Stop Ring) x 1 | 0.02 | BD040-SK-SRING |
| | 29 Shroud | 2.2 | BD040-SHROUD-136/134 |
| | 30 Drive Sub | 3.67 | BD040-DSUB |
| | 31 Drill Bit | 15.09 | BD040-136DC=TV |
| | 32 Seal Kit (Item2(1)+5(4)+8+14+15+16+19+25+26+28) | 0.2 | BD040-SK |

Technical Data

| Length(Less bit) | Weight(Less bit) | External Diameter | Bit Shank | Hole Range | Connection Thread |
|------------------|-----------------------|----------------------------|-----------------|------------|--|
| 1362mm | 80.5kg | Φ120.5mm | BD040 | Φ124- Φ142 | 3.5" – 4.5" Remet 3.5"- 4.5" Metzke |
| Working Pressure | Impact rate At 2.4Mpa | Recommended rotation speed | Air Consumption | | |
| 1.5-3.5Mpa | 35Hz | 25-40r/min | 200-500(PSI) | | |
| | | | 300-1200(CFM) | | |